



भारतीय प्रबंध संस्थान इन्दौर

प्रबंध शिखर, राऊ-पीथमपुर रोड, इन्दौर - 453 556 (म.प्र.), भारत

INDIAN INSTITUTE OF MANAGEMENT INDORE
Prabandh Shikhar, Rau-Pithampur Road, Indore - 453 556 (M.P.), India

May 07, 2022

NOTICE INVITING TENDER (NIT No.: IIMI/Estate/09/2022/99 File No. 335)

Subject: "Construction of composting pits and shed in the waste management area at IIM Indore".

Dear Sir,

Enclosed please find a schedule of items for which your competitive rate is invited. The lowest bidder is required to execute the work at site under works contract mode.

संलग्न कृपया उन वस्तुओं का शेड्यूल ढूँढें, जिनके लिए आपकी प्रतिस्पर्धी दर आमंत्रित की गई है। कार्य अनुबंध मोड के तहत साइट पर कार्य को निष्पादित करने के लिए सबसे कम बोली लगाने वाले की आवश्यकता है।

1. NIT Details About Institute: -

1	NIT No.	
2	Name of Work	Construction of composting pits and shed in the waste management area at IIM Indore
3	Estimated Cost	Rs 4,96,238/- (Rupees Four Lakh Ninety Six Thousand Two Hundred Thirty Eight Only) excluding GST.
4	अग्रिम जमा राशि Earnest Money Deposit (Rs.)	Rs 9,925/- by DD or NEFT to be deposited
5	समापन की अवधि Completion period	90 days
6	प्रकाशित करने का दिनांक Date of Publishing	May 07, 2022.
7	Pre-Bid Meeting	No pre-bid meeting required. Instead of pre-bid meeting, interested bidder are advised to visit the Institute & inspect the scope before participate in tender. You have to request for entry permission in advance through email on estatecivil@iimdr.ac.in (contact number 0731-2439618)
8	निविदा के जमा करने की अंतिम तिथि और समय Last date & time of receipt of tender	May 12, 2022 Up to 2:30 PM in a Sealed cover only addressed to the "Chief Engineer, IIM Indore" The bid has to be dropped in the Tender Box kept at the "Gate - 1, IIM Indore,

		Rau Pithampur Road Indore - 453556 M.P” on or before the due date & time positively.
9	तकनीकी बोली के खोलने की तिथि और समय Date & Time of opening of technical bid	03:00 PM on May 12, 2022 in the Estate Office.
10	वित्तीय बोली के खोलने की तिथि और समय Date & Time of opening of Financial bid	To be communicated to all technically qualified bidder by email.
11	प्रतिभूति जमा Security Deposit	2.5% gross amount of final bill
12	परफॉर्मन्स गारंटी Performance Guarantee	बोली की स्वीकृति पर निविदा मूल्य का 3 (three)% 3% of tendered value on acceptance of bid. (The contractor whose bid is accepted will be required to furnish performance guarantee of 3 % (Three Percent) of the bid amount within Seven days of issue of LOI. The amount of PG will be transfer through NEFT or RTGS on account of IIMI, details are:- Name of beneficiary: Indian Institute of Management Indore. Address: Rau-Pithampur Road, Indore -453556, M.P. Account No. : 53018623445 Name of the Bank : State Bank of India Address of the bank : IIM Indore Campus IFSC Code : SBIN0030525

All statutory recoveries applicable to works contract will be deducted from the bill.

1. Specification prescribed by CPWD shall be followed.
2. GCC MAINTENANCE WORKS 2020 as per CPWD shall be followed.
3. Deviated quantity of BOQ item more than 50 % or any item which is not available in the BOQ shall be paid as per DSR 2021 rates. If it is not available in BOQ & DSR 2021 then extra item shall be worked out by market rate analysis. The decision of Engineer-in-charge will be conclusive and final binding on the contractor.
4. Legal responsibility shall be borne by the contractor to keep the employees/workers who might be affected from harm or any injury at site.

2. Eligibility Criteria:

Criteria of eligibility for submission of bid documents:

2.1 Cover-I: Techno-Commercial Bid



भारतीय प्रबंध संस्थान इन्दौर

प्रबंध शिखर, राज-पीथमपुर रोड, इन्दौर - 453 556 (म.प्र.), भारत

INDIAN INSTITUTE OF MANAGEMENT INDORE
Prabandh Shikhar, Rau-Pithampur Road, Indore - 453 556 (M.P.), India

(a) Performance / Work Experience

One similar completed work, costing not less than the amount equal to 3,96,990/-
OR

Two similar completed works, costing not less than the amount equal to 2,97,743/-
OR

Three similar completed works costing not less than the amount equal to 1,98,495/-,

Similar work shall mean: Civil work/Truss/MS Structure.

(b) Certificates: (copy of certificates to be submitted)

- i. PAN (Permanent Account Number)
- ii. GST (Goods & Service Tax) Registration Certificate
- iii. Certificate of registration of firm/company
- iv. Aadhar card copy of the authorized officer of the company who will be signing agreement etc.
- v. Bank Account Detail.
- vi. Proof of deposit of EMD.

Past performance in IIM Indore: Bidder, whose past performance in jobs carried out in IIMI, is found to be unsatisfactory, will be disqualified technically even though they may meet the other technical/eligibility criteria.

2.2 Cover-II: Financial Bid

- i) Financial Bid (in the format given at Annexure-A)

Both covers should be kept in one main sealed cover super scribed as "NIT No.: IIMI/Estate/09/2022/99 File No. 335, "Construction of composting pits and shed in the waste management area at IIM Indore" at IIM Indore.

The bid has to be dropped in the Tender Box kept at the "Gate - 1, IIM Indore, Rau Pithampur Road Indore - 453-556 (M.P.)" on or before the due date & time positively. The Bid shall not be accepted beyond the stipulated date and time under any circumstances whatsoever. Any delay happened in the transition is at the risk of the bidder and IIM Indore will not be responsible.

3. Payment Terms:

- a. Payment shall be made under actual measurement.
- b. Contractor should get registered under GST and tax as applicable as per the extant order on the subject contract shall be paid by the contractor to concerned department which will be reimbursed/paid by the Institute as per the recommendation of Finance & Accounts department of the Institute & the same will be final & binding to the contractor.
- c. Income Tax and cess as applicable shall be deducted from bill paid to the contractor.
- d. Any other taxes/cess as per government directives shall be deducted from bill paid to the contractor from time to time.
- e. The performance guarantee shall be refunded to the contractor 60 days after the completion of the work/service and recording of the completion certificate as above.
- f. Security Deposit will be released after One year from the actual date of completion of work.

- g. Payment to be made online to vendor's bank account. Vendor must give details of the bank account for online transaction of payment after completion of job to the satisfaction of institute representative.

4. **Scope of work:**

- Construction of steel structure in tubular section / trusses etc.
- Providing & Fixing Trapezoidal zincalume sheet over truss.
- Construction of compost pits in brick work.
- Truss drawing with sheets fixing to be submitted for approval.
- PPE- Personal portative equipment like helmet, safety belt, safety shoes, goggles & glubs to be provided to all workers.

Note: - All the work to be executed as per tender document/ CPWD technical specifications etc. & prior approval of material make from IIMI.

5. **List of Approved Make/ Materials: -**

S.No.	Material	Manufacturer/ Brand Name
1	Ordinary Portland Cement.	JK/ Ambuja/ Ultratech or equivalent
2	Structural steel sections	Tata/Jindal/Apollo or Equivalent as approved by client
3	Zincalume sheet	Tata colourbond XRW/Jindal or equivalent as approved by client
4	All other materials	As approved by the Client

6. **Completion Period:**

90 days from the date of Start.

7. **Compensation for delay:**

1% (One Percent) per month of delay to be computed on per day basis. The total amount of compensation for delay to be paid under this Condition shall not exceed 10% of the Tendered Value of work or of the Tendered Value of the item or group of items of work for which a separate period of completion is originally given.



Chief Engineer

(Enclosed: Financial bid)

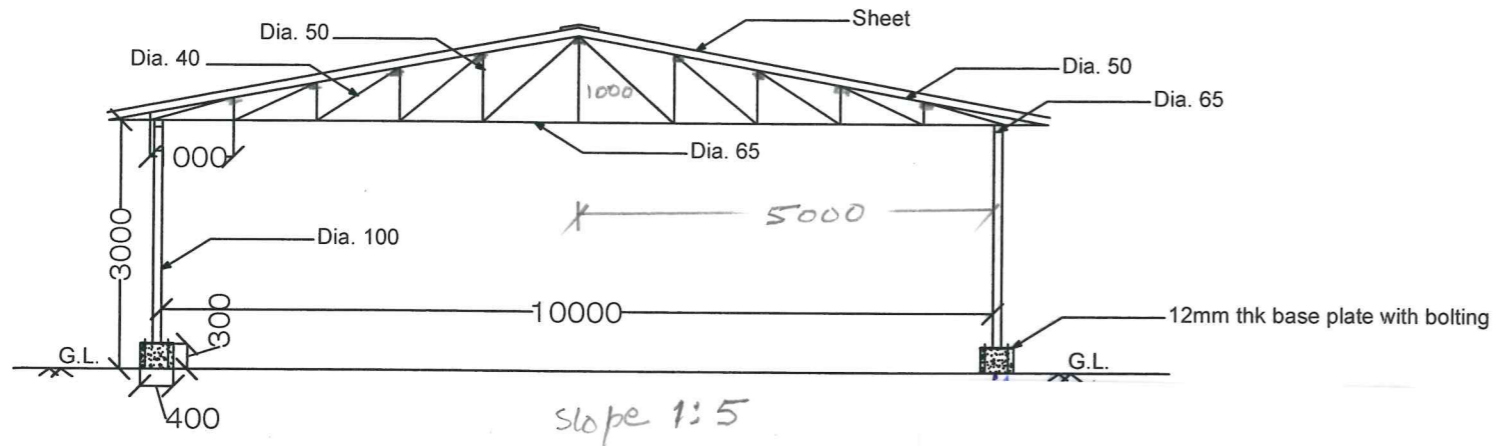

Section View

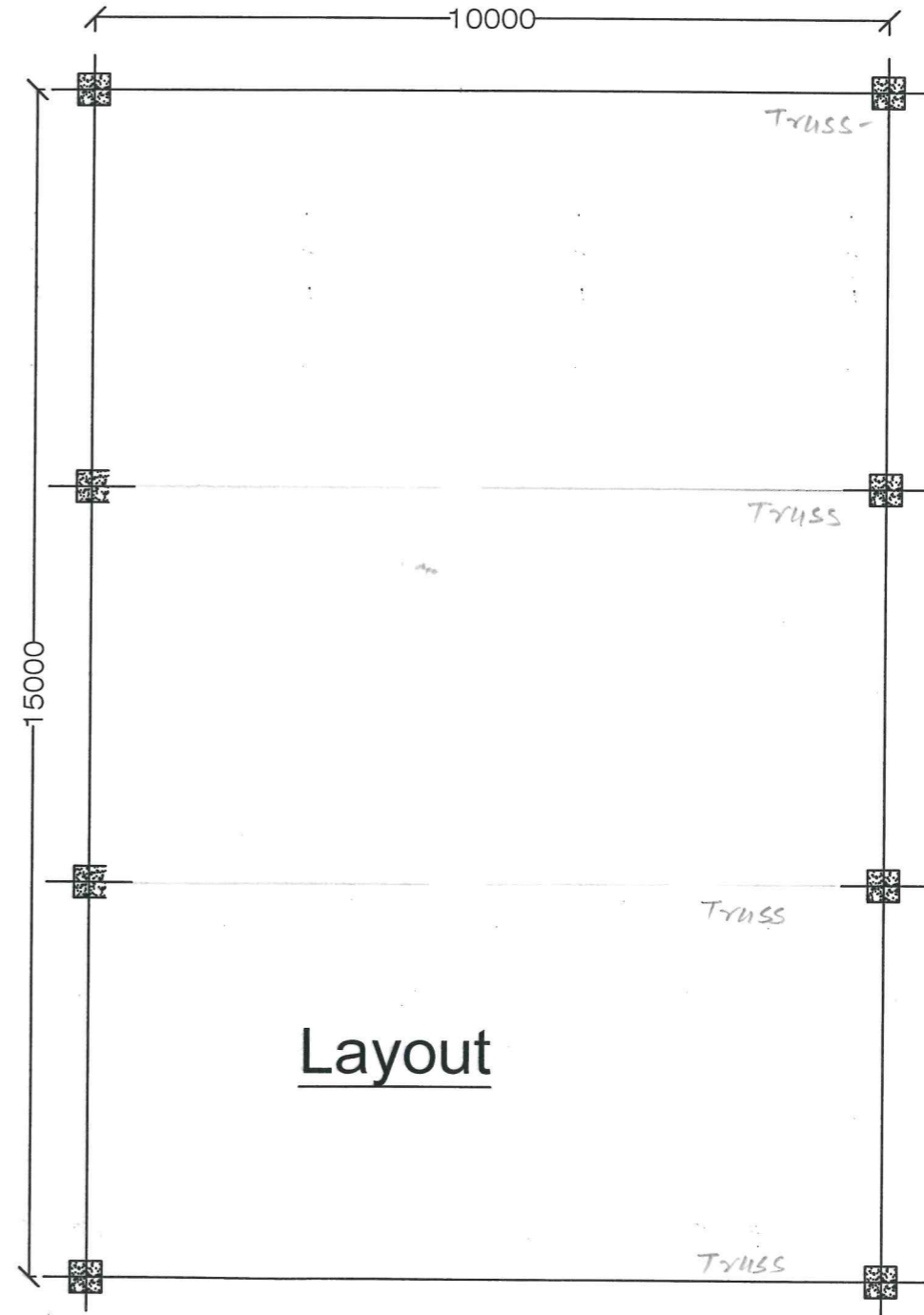

Layout

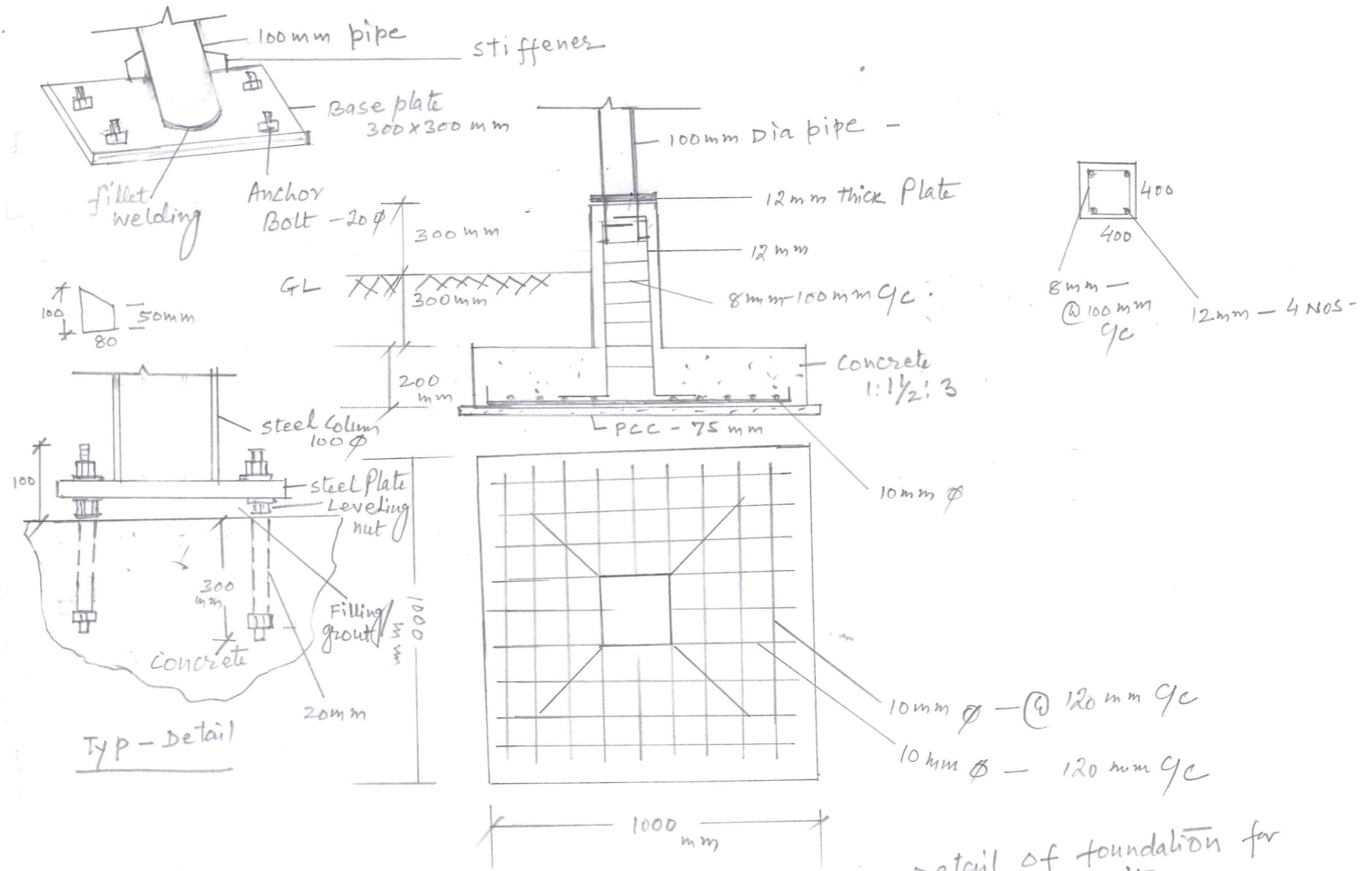

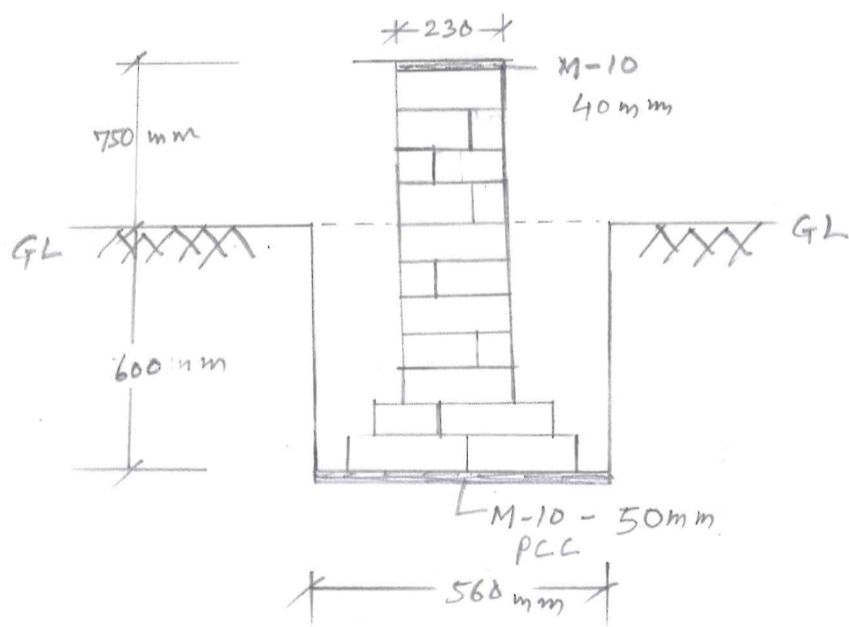
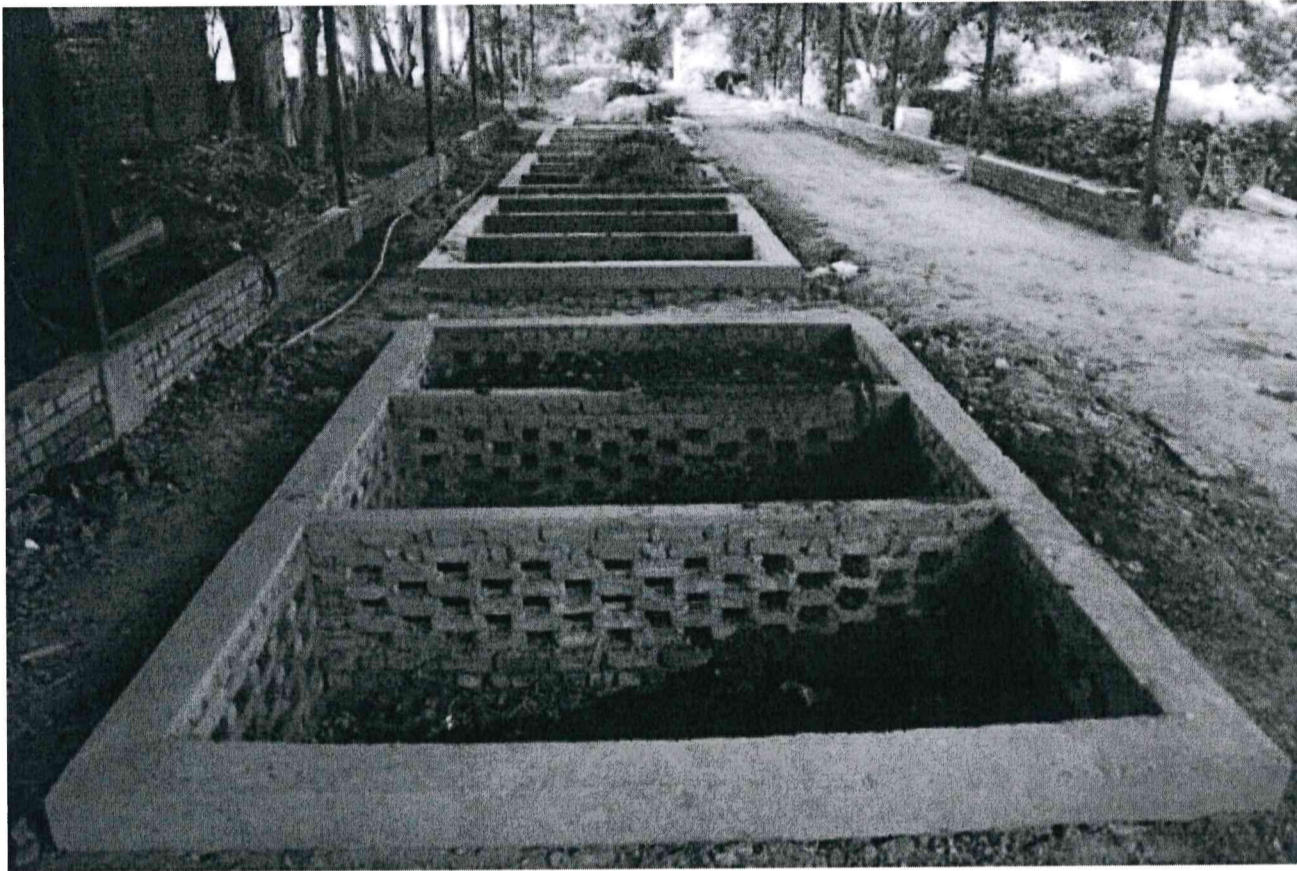

Annexure A

INDIAN INSTITUTE OF MANAGEMENT INDORE						
Financial Bid						
Name of Work: Construction of composting pits and shed in the waste management area at IIM Indore						
S.No	Item Description	Qty	Unit	Rate (Excl GST)	Amount	Amount in Words
1	Earth work in excavation by mechanical means (Hydraulic excavator)/ manual means over areas (exceeding 30 cm in depth, 1.5 m in width as well as 10 sqm on plan) including getting out and disposal of excavated earth lead upto 50 m and lift upto 1.5 m, as directed by Engineer-in-charge. All kinds of soil	17	Cum			
2	Concrete of M10 grade with minimum cement	1.5	cum			
3	Providing and laying in position specified grade of reinforced cement concrete, excluding the cost of centering, shuttering, finishing and reinforcement - All work up to plinth level : 1:1.5:3 (1 cement : 1.5 coarse sand (zone-III) derived from natural sources : 3 graded stone aggregate 20 mm nominal size derived from natural sources)	2.5	Cum			
4	Steel reinforcement for R.C.C. work including straightening, cutting, bending, placing in position and binding all complete upto plinth level. Thermo-Mechanically Treated bars of grade Fe-500D or more	150	kg			
5	Centering and shuttering including strutting, propping etc. and removal of form for Foundations, footings, bases of columns, etc. for mass concrete	16	Sqm			
6	Steel work in built up tubular (round) trusses etc., including cutting, welding, hoisting, fixing in position and applying a priming coat of approved steel primer, including welding and bolted with special shaped washers etc. complete. Hot finished seamless type tubes. (The detail shop drawing of the truss shall be submitted for approval before procurement of the material).	1470	kg.			

7	Providing and fixing trapezoidal zinalume/ galvolume sheets . The sheets are to be fixed in roofing on structural steel framing. The sheets are to be fixed using J-hooks/ Screws. The sheet is to be of 0.45mm thick having 550Mpa yeild strength.Epoxy filling over screws at sheets to be done to prtect leakage of water.	160	Sqm			
8	Painting with synthetic enamel paint of approved brand and manufacture to give an even shade : Two or more coats on new work	90	Sqm			
9	Brickwork with common burnt clay F.P.S. (non modular) bricks of class 7.5 in foundation and plinth in :cement mortar 1:4 (1 cement : 4 coarse sand)	10	Cum			

Grand Total (Exculding GST)

Name of firm _____	Email Address _____
Authorized Person _____	
Contact Number _____	Signature & Seal _____